

UNIVERSITY OF NEBRASKA-LINCOLN

FACILITIES DEVELOPMENT PLAN

2022 UPDATE | APPENDIX





APPENDIX

Section A - Appendix documents the data and comments received in the virtual survey conducted in January 2022.

The 2022 University of Nebraska-Lincoln (UNL), Facilities Development Plan (FDP) update (Plan) is an interim update of the 2013 UNL Campus and Landscape Master Plan to articulate the University's current goals and objectives until the subsequent 10 year vision FDP.

An online survey was developed for UNL stakeholders, faculty, students and staff to provide feedback, desires, and insights. The following summary of the data and comments are included in the following pages.

Q1

I am a . . .

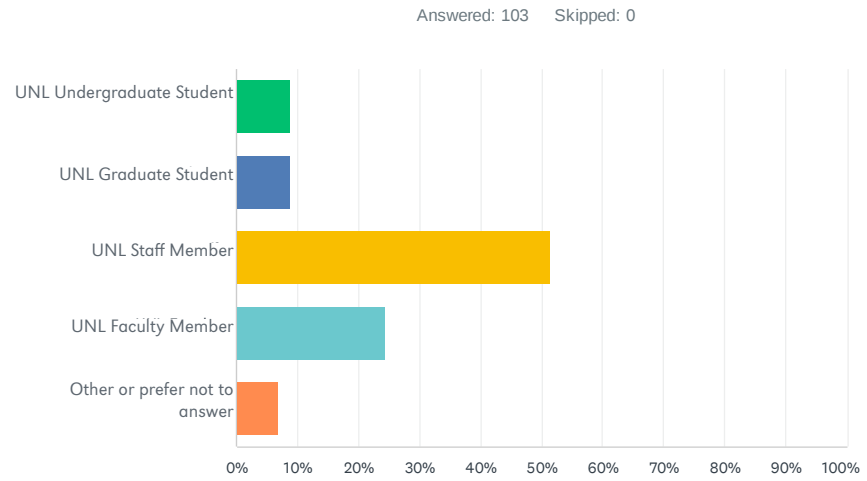

ANSWER CHOICES	RESPONSES	
UNL Undergraduate Student.	8.74%	9
UNL Graduate Student.	8.74%	9
UNL Staff Member.	51.46%	53
UNL Faculty Member.	24.27%	25
Other or prefer not to answer.	6.80%	7
TOTAL		103

Q2

What campus open spaces are needed to improve campus experience?

Please rank in order of importance.

Answered: 138 Skipped: 0

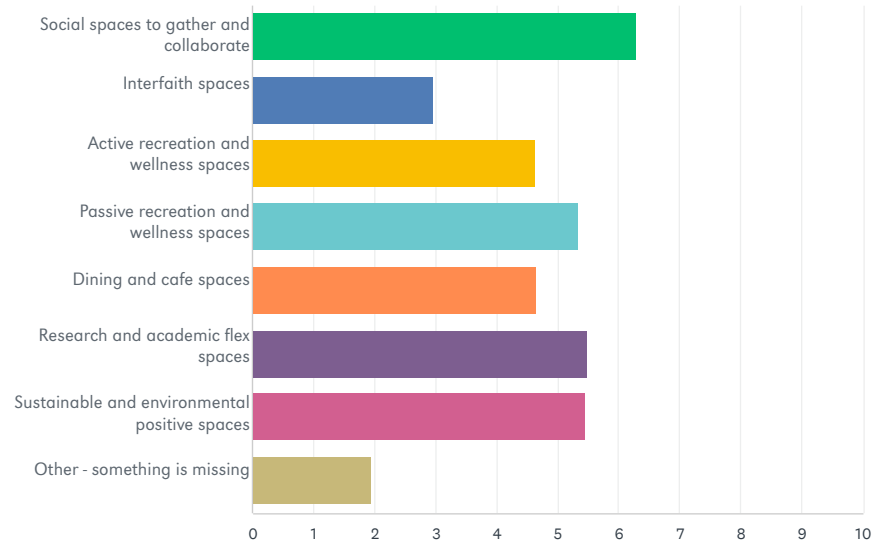

	1	2	3	4	5	6	7	8	TOTAL	SCORE
Social spaces to gather and collaborate.	34.07% 46	20.00% 27	17.78% 24	8.89% 12	8.89% 12	8.15% 11	2.22% 3	0.00% 0	135	6.28
Interfaith spaces.	3.28% 4	2.46% 3	6.56% 8	3.28% 4	12.30% 15	13.11% 16	50.00% 61	9.02% 11	122	2.97
Active recreation and wellness spaces.	3.73% 5	8.96% 12	17.16% 23	22.39% 30	21.64% 29	17.16% 23	8.21% 11	0.75% 1	134	4.63
Passive recreation and wellness spaces.	6.62% 9	19.12% 26	18.38% 25	26.47% 36	18.38% 25	7.35% 10	3.68% 5	0.00% 0	136	5.32
Dining and café spaces.	5.19% 7	17.78% 24	11.11% 15	15.56% 21	14.81% 20	23.70% 32	11.11% 15	0.74% 1	135	4.64
Research and academic flex spaces.	20.44% 28	18.98% 26	12.41% 17	13.87% 19	11.68% 16	15.33% 21	6.57% 9	0.73% 1	137	5.47
Sustainable and environmental positive spaces.	25.36% 35	13.04% 18	17.39% 24	8.70% 12	10.14% 14	13.04% 18	10.87% 15	1.45% 2	138	5.45
Other - something is missing.	5.80% 4	1.45% 1	2.90% 2	2.90% 2	2.90% 2	1.45% 1	7.25% 5	75.36% 52	69	1.94

Q2

Answered: 14 Skipped: 124

If you ranked
 “Other - something is missing,”
 what campus open space is
 missing?

Use the comment box below to tell us:

#	RESPONSES	DATE
1	It would be better if Chik-Fil-A was replaced with a friendlier restaurant. It has too many connections to ideologies that do not align with UNL and affiliates. Having a dairy store section in the Union would also be beneficial, as well as offering it in dining halls to branch out to more students and employees.	2/3/2022 12:53 PM
2	Art space	2/1/2022 6:40 PM
3	Small-medium sized gathering spaces (4 to 10 tables) with good access to electricity in multiple buildings.	1/31/2022 10:48 AM
4	Residence Halls!	1/26/2022 7:41 PM
5	Areas to recycle unusual items (textiles/clothing, electronics, etc.)	1/25/2022 5:11 PM
6	More spaces explicitly safe and welcoming for marginalized groups, including but especially LGBTQA+ students, faculty, and staff.	1/25/2022 1:03 PM
7	Seems important to state here that overwhelming student debt is a major deterrent to people entering my field and a major stressor for those in it. Keeping built spaces non-extravagant in an effort to keep tuition affordable needs to be kept top-of-mind.	1/24/2022 10:17 AM
8	Areas for solitary study - places for students who need quiet and fewer distractions to concentrate and focus. This is especially important for off-campus graduate students and non-traditional students who need easy access to low-distraction study areas.	1/19/2022 4:32 PM
9	Flying squirrel viewing space	1/19/2022 3:53 PM
10	I don't understand what some of these labels are supposed to mean, and I don't understand the question. We have many of these things - is the question whether we need more or to improve the ones that exist?	1/19/2022 11:24 AM
11	Improve and maintain both CC and EC landscape perimeter imageability.	1/19/2022 10:56 AM
12	Mothers Rooms clearly marked in maps (and more options available). Also, wayfinding/navigational signage on campuses (especially East Campus)	1/19/2022 10:53 AM
13	Parking for prospective graduate students who are visiting.	1/19/2022 10:48 AM
14	Inclusive and multicultural community spaces	1/18/2022 10:42 AM

Q3

What methods would best celebrate diversity, enhance inclusivity, and build community on campus?

Please rank each method in order of importance.

Answered: 118 Skipped: 0

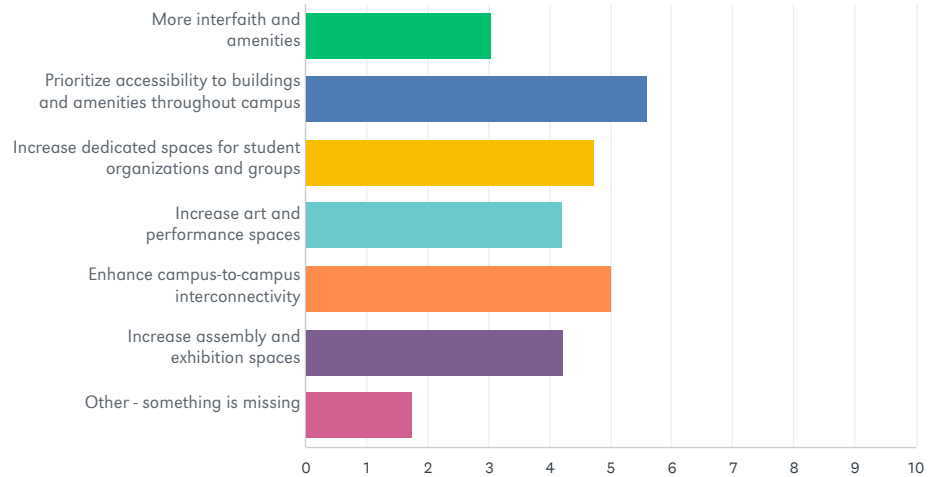

	1	2	3	4	5	6	7	TOTAL	SCORE
More interfaith spaces and amenities.	2.83% 3	10.38% 11	9.43% 10	7.55% 8	15.09% 16	44.34% 47	10.38% 11	106	3.04
Prioritize accessibility to buildings and amenities throughout campus.	40.17% 47	16.24% 19	16.24% 19	17.95% 21	9.40% 11	0.00% 0	0.00% 0	117	5.60
Increase dedicated spaces for student organizations and groups.	14.78% 17	14.78% 17	26.96% 31	23.48% 27	13.04% 15	6.96% 8	0.00% 0	115	4.74
Increase art and performance spaces.	5.26% 6	17.54% 20	18.42% 21	23.68% 27	21.93% 25	11.40% 13	1.75% 2	114	4.19
Enhance campus-to-campus interconnectivity.	25.00% 29	23.28% 27	13.79% 16	12.93% 15	17.24% 20	6.03% 7	1.72% 2	116	5.01
Increase assembly and exhibition spaces.	8.70% 10	20.00% 23	17.39% 20	13.91% 16	19.13% 22	20.00% 23	0.87% 1	115	4.22
Other - something is missing.	9.62% 5	0.00% 0	0.00% 0	0.00% 0	3.85% 2	9.62% 5	76.92% 40	52	1.75

Q3

If you ranked
“Other - something is missing,”
what community focus method
is missing?

Use the comment box below to tell us:

Answered: 9 Skipped: 109

#	RESPONSES	DATE
1	Remove Greek housing that cannot follow basic rules of UNL and the surrounding community, and reward those that do.	2/3/2022 12:58 PM
2	This revolves more around events than spaces. There are plenty of spaces, but attendance at student involvement events is a tiny fraction of the student body. Nobody has a reason to leave, all the spaces in the world don't matter.	1/31/2022 10:50 AM
3	Increase current lab, office, classroom & collaboration space for academic departments, schools, centers, etc. Increase multipurpose classroom space on East Campus.	1/27/2022 3:45 PM
4	Spaces for smart students to congregate; gender inclusive	1/26/2022 7:47 PM
5	Honestly the biggest tragedy of recent updates is the lack of books and other media at Dinsdale. It's a glorified study hall.	1/25/2022 1:05 PM
6	I really have no idea if there is a shortage of any of the above as I am stationed off campus. Our facility is currently supplying all the spaces we need for the things we do.	1/24/2022 10:41 AM
7	utilize space to highlight diversity - think intentionally about pictures and art which would help diverse students, faculty and staff see themselves at our university.	1/20/2022 8:43 AM
8	Renovate and expand the Nebraska Union.	1/19/2022 10:55 AM
9	Prioritize working with existing multicultural organizations (OASIS, LGBTQA+ Center, Women's Center, etc.) to improve resources and outreach	1/18/2022 10:50 AM

What methods would best enhance mobility between, through and to/from the campuses for students, employees, and visitors?

Please rank each method in order of importance.

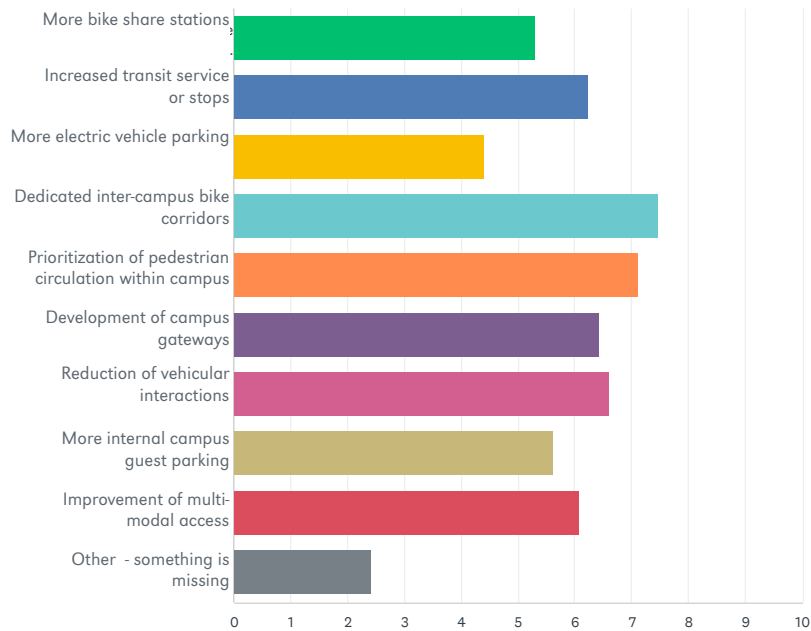

Answered: 114 Skipped: 0

	1	2	3	4	5	6	7	8	9	10	TOTAL
More bike share stations.	5.26% 5	8.42% 8	5.26% 5	9.47% 9	11.58% 11	20.00% 19	11.58% 11	22.11% 21	5.26% 5	1.05% 1	95
Increased transit services or stops.	11.00% 11	11.00% 11	10.00% 10	13.00% 13	15.00% 15	9.00% 9	18.00% 18	11.00% 11	2.00% 2	0.00% 0	100
More electric vehicle parking.	4.21% 4	3.16% 3	7.37% 7	2.11% 2	13.68% 13	11.58% 11	16.84% 16	11.58% 11	26.32% 25	3.16% 3	95
Dedicated inter-campus bike corridors.	22.33% 23	22.33% 23	11.65% 12	12.62% 13	7.77% 8	10.68% 11	6.80% 7	2.91% 3	1.94% 2	0.97% 1	103
Prioritization of pedestrian circulation within campus.	20.79% 21	13.86% 14	13.86% 14	16.83% 17	9.90% 10	5.94% 6	8.91% 9	6.93% 7	2.97% 3	0.00% 0	101
Development of campus gateways and entry points for non-motorized traffic.	9.09% 9	15.15% 15	11.11% 11	13.13% 13	17.17% 17	11.11% 11	11.11% 11	9.09% 9	2.02% 2	1.01% 1	99
Reduction of vehicular interactions with pedestrian and bicycle corridors.	12.26% 13	14.15% 15	18.87% 20	15.09% 16	8.49% 9	5.66% 6	7.55% 8	9.43% 10	7.55% 8	0.94% 1	106
More internal campus guest parking.	14.00% 14	9.00% 9	13.00% 13	10.00% 10	7.00% 7	5.00% 5	4.00% 4	12.00% 12	22.00% 22	4.00% 4	100
Improvement of multi-modal access to and from campus to greater Lincoln.	7.55% 8	13.21% 14	16.04% 17	12.26% 13	9.43% 10	13.21% 14	6.60% 7	7.55% 8	12.26% 13	1.89% 2	106
Other - something is missing.	9.09% 5	0.00% 0	3.64% 2	1.82% 1	1.82% 1	1.82% 1	0.00% 0	0.00% 0	9.09% 5	72.73% 40	55

Q4

If you selected
 “Other - something is missing,”
 what mobility method
 is missing?

Use the comment box below to tell us:

1	With the future construction plans, is parking being considered? For example, the plans to redo Westbrook will attract many new people to campus. Are there plans to expand parking in that area? Or for Nebraska Hall's or Mabel Lee's current construction, is there a plan to make more spaces available? What about the parking that is removed from use during that construction time?	2/3/2022 1:17 PM
2	Dedicated bike paths is a huge deal. It is almost impossible to safely navigate campus on a bike with how people take up entire sidewalks with 0 awareness of their surroundings. Also pedestrian bridges, especially over Holdrege street to east campus, are sorely needed. Safer/more secure, preferably indoor bike parking is needed as many bikes have been stolen outside Hardin Hall.	2/2/2022 11:11 AM
3	I think there should be university student only transit system between campuses, and also to major locations in Lincoln (i.e. housing areas, malls, super grocery stores) that would make campus more accessible and transit easy for international and out-of-state students without cars	2/1/2022 8:37 PM
4	Free parking on campus for faculty and staff. Parking prices are pretty expensive; there should be either no or very low cost to park at your workplace.	2/1/2022 8:46 AM
5	More parking for temporary, short-term uses, such as loading and unloading without having to have a permit or having to carry things for blocks to get to the right building.	1/31/2022 12:59 PM
6	Walking outside when it's cold (over half of the school year) is TERRIBLE. Why is Engineering the only smart ones with buildings made for cross campus transit indoors? It's faster to get to Jorgenson by walking around the Education buildings than it is through them.	1/31/2022 10:53 AM
7	We need to be careful that we keep things accessible for people with disabilities, how will they access areas where traffic is cut off, will they be excluded from the interior or could they have a special parking pass that lifts a gate so they can get close to where they need to go?	1/28/2022 2:13 PM
8	Possibly some sort of rideshare system between campuses?	1/27/2022 12:44 PM
9	Bus or trolley from both UNL campuses to downtown and the haymarket	1/25/2022 5:14 PM
10	Put the cost of semester-to-semester parking passes on a sliding scale. Why should I, who makes about \$40k/year, have to pay the same as some faculty who makes twice that and isn't even on-campus every day?	1/25/2022 1:07 PM
11	I have no idea which of these are needed.	1/24/2022 10:42 AM
12	Why more EV parking? EVs can use existing parking solutions. Or do you mean EV parking with charging stations?	1/19/2022 4:35 PM
13	More Parking	1/19/2022 3:02 PM
14	Stop reducing parking and moving it so far from so many buildings. It's anti-inclusive to force people with disabilities or pregnant people to park and travel long distances just to get to work or class.	1/19/2022 11:30 AM
15	Additional incentives for students and staff to walk/bike/bus more, drive less.	1/19/2022 10:22 AM

Q5

UNL Design and Experience.

Prioritize the following:

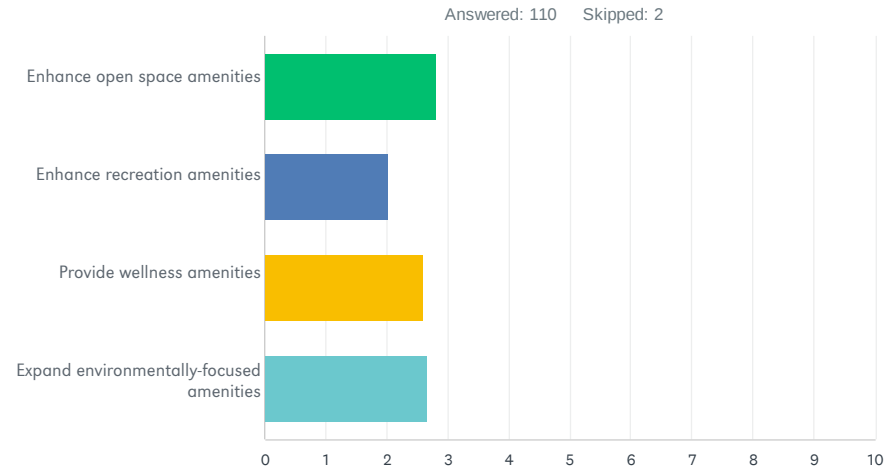

	1	2	3	4	TOTAL	SCORE
Enhance open space amenities.	34.91% 37	27.36% 29	22.64% 24	15.09% 16	106	2.82
Enhance recreation amenities.	8.57% 9	24.76% 26	26.67% 28	40.00% 42	105	2.02
Provide wellness amenities.	24.53% 26	31.13% 33	25.47% 27	18.87% 20	106	2.61
Expand environmentally-focused amenities.	35.51% 38	18.69% 20	23.36% 25	22.43% 24	107	2.67

Q6

UNL Community Focus. Prioritize the following:

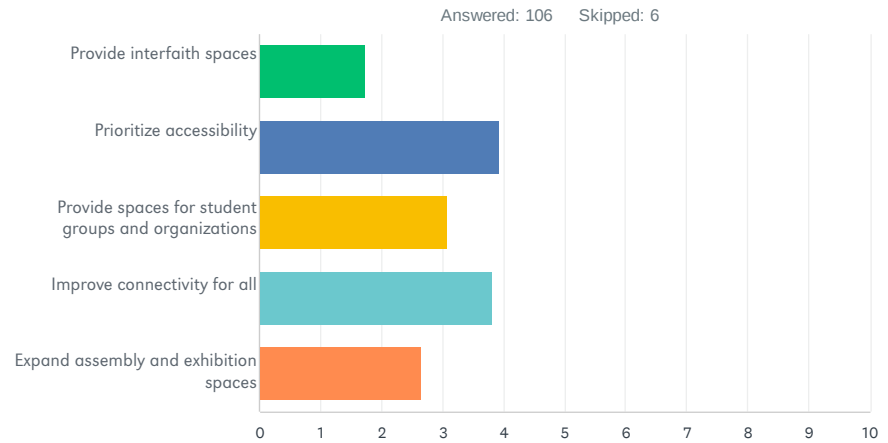

	1	2	3	4	5	TOTAL	SCORE
Provide interfaith spaces.	4.21% 4	8.42% 8	7.37% 7	15.79% 15	64.21% 61	95	1.73
Prioritize accessibility.	40.95% 43	26.67% 28	18.10% 19	13.33% 14	0.95% 1	105	3.93
Provide spaces for student groups and organizations.	15.84% 16	18.81% 19	30.69% 31	26.73% 27	7.92% 8	101	3.08
Improve connectivity for all.	34.62% 36	28.85% 30	20.19% 21	15.38% 16	0.96% 1	104	3.81
Expand assembly and exhibition spaces.	6.93% 7	20.79% 21	24.75% 25	24.75% 25	22.77% 23	101	2.64

UNL Getting Around.

Prioritize the following:

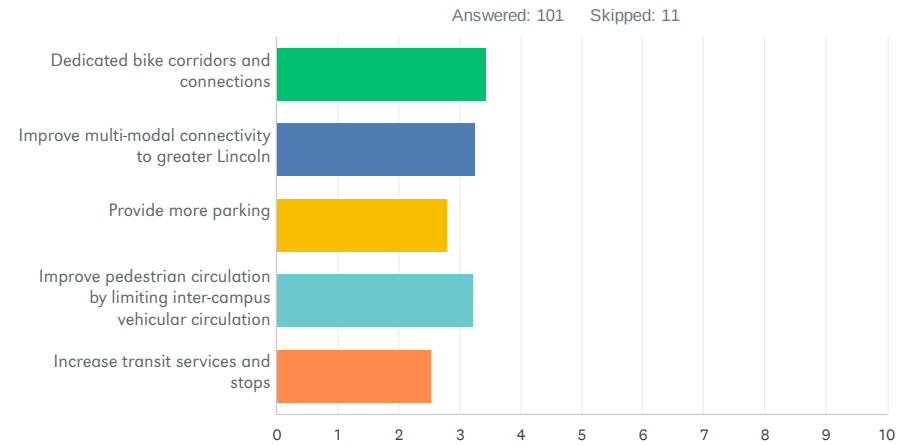

	1	2	3	4	5	TOTAL	SCORE
Dedicated bike corridors and connections.	27.84% 27	22.68% 22	24.74% 24	15.46% 15	9.28% 9	97	3.44
Improve multi-modal connectivity to greater Lincoln.	13.13% 13	28.28% 28	36.36% 36	17.17% 17	5.05% 5	99	3.27
Provide more parking.	31.96% 31	10.31% 10	5.15% 5	10.31% 10	42.27% 41	97	2.79
Improve pedestrian circulation by limiting inter-campus vehicular circulation.	26.04% 25	21.88% 21	19.79% 19	12.50% 12	19.79% 19	96	3.22
Increase transit services and stops.	5.15% 5	19.59% 19	15.46% 15	42.27% 41	17.53% 17	97	2.53

Q8

UNL Sustainability and Resilience.

Prioritize the following:

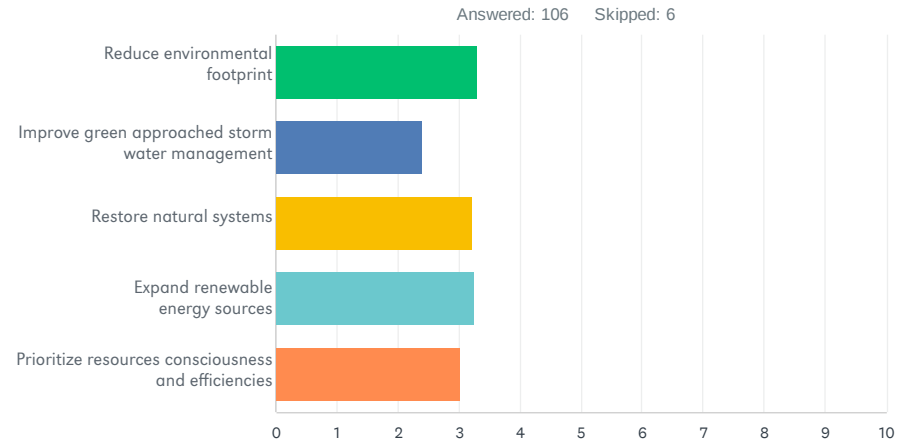

	1	2	3	4	5	TOTAL	SCORE
Reduce environmental footprint.	26.47% 27	19.61% 20	27.45% 28	11.76% 12	14.71% 15	102	3.31
Improve green approached stormwater management.	3.96% 4	18.81% 19	18.81% 19	29.70% 30	28.71% 29	101	2.40
Restore natural systems.	22.00% 22	25.00% 25	19.00% 19	21.00% 21	13.00% 13	100	3.22
Expand renewable energy sources.	29.70% 30	17.82% 18	16.83% 17	19.80% 20	15.84% 16	101	3.26
Prioritize resource consciousness and efficiencies.	22.33% 23	21.36% 22	17.48% 18	14.56% 15	24.27% 25	103	3.03

Q9

UNL Academics and Research.

Prioritize the following:

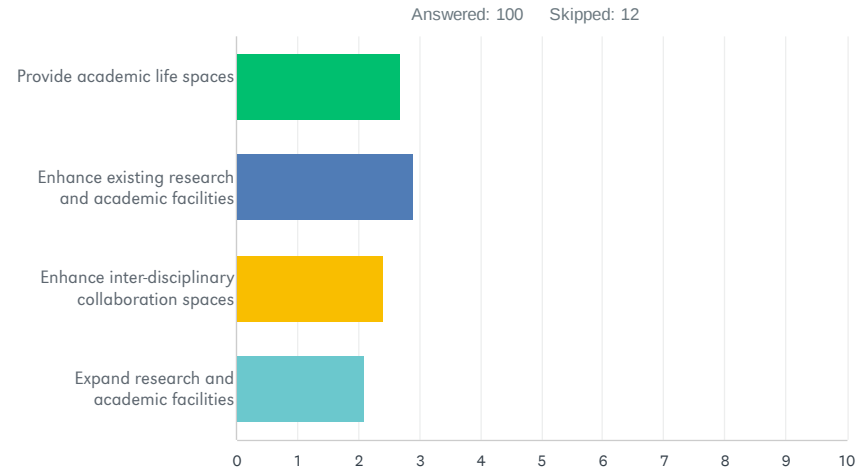

	1	2	3	4	TOTAL	SCORE
Provide academic life spaces (e.g., collaboration/group study, maker spaces, or individual spaces).	33.68% 32	25.26% 24	16.84% 16	24.21% 23	95	2.68
Enhance existing research and academic facilities.	35.71% 35	27.55% 27	28.57% 28	8.16% 8	98	2.91
Enhance inter-disciplinary collaboration spaces.	18.56% 18	25.77% 25	35.05% 34	20.62% 20	97	2.42
Expand research and academic facilities.	15.96% 15	21.28% 20	18.09% 17	44.68% 42	94	2.09

Q10

What does campus need more of?

Use the comment box below to tell us:

Answered: 68 Skipped: 4

#	RESPONSES
1	Visual uniform branding to help showcase you are on campus and in the UNL community. There are great features that give uniqueness to campus, but on either campus its sometimes hard to say I'm at UNL over another college campus. From the street to pedestrians, it could be any Big 10 campus in parts.
2	Parking for pass holders and meter parking. Affordable meal plans for off-campus students who only need a few meals a month on campus. Study spaces throughout campus for working in between classes.
3	Parking
4	Environmentally conscious disposal, parking closer to campus, more emphasis on carpooling or other sustainable traveling options, and a solar farm (or at least more solar energy being used to power facilities).
5	Campus needs more commuter parking areas around campus, towards the south or middle area of campus.
6	Parking. Bus connectivity with the city. I live by Holmes Lake, which is a 7 mi bike ride (35 min) to city campus. It would take me 45 minutes to get to campus by bus. Recycling bins. Native plants and grasses. Taller buildings so stuff doesnt havent to be so spread out. Better, easier to use printing kiosks (any time I've tried to print on campus, the kiosk is broken and the only other kiosk is halfway across campus, or I cant figure out how to pay for printing without downloading another stupid "app" which my ancient phone cant even download). The health center needs more parking, I cant find a place to park sometimes for my physical therapy appointments.
7	buses for students, we rely on stupid startran where students occasionally face unsafe encounters with drunkards, there should be student only buses between campuses and to different areas in Lincoln, or maybe a subway system; also, there are very few places and very limited options to get coffee on city and east campuses, we need more safety options for female students for example mid-night shuttle service to their homes (to locations near the campus - where 90% of students live)
8	More parking on campus, and it should be low or no cost. Often have to go to city campus super early for meetings in order to get parking that isn't long distance from meeting space.
9	Guest Parking on East Campus
10	Parking spots, pedestrian 'short cuts'
11	Fulltime practicing faculty instead of graduate students teaching many undergraduate sections.
12	Probably parking that is sufficiently close to buildings for ease of access to those spaces if need be.
13	Wide, multi-use pathways for pedestrians and bicycles/scooters
14	Better internet connectivity, more bike rental stations, and more internal meeting and study spaces
15	Active solicitation of engagement in meaningful governance from the student body.
16	Accessibility, environmentally conscious design, private collaboration spaces, internet connectivity, Eduroam is and has been terrible
17	Spaces for student organizations to gather informally. The Nebraska Union facilities are so booked, many RSOs cant find physical space to informally gather. Accessible RSO space is missing on this campus.
18	1. Parking with lower-cost parking. 2. East Campus or Innovation Campus dorms. 3. Married Student Housing at reasonable rates.
19	Areas without surface parking lots

What does campus need more of?

Use the comment box below to tell us:

Q10

20	Guest parking is critical. This allows community access to university resources including museums, sport facilities, and other amenities	43	Year around mass transit between 3 campuses in Lincoln and connection to food stores
21	Improved building access, accommodations, and signage for those with disabilities. Improved energy efficiency.	44	Safe and quick non-vehicular routes among the different campuses (esp. East Campus and Innovation Campus).
22	Parking/transit stops and sustainability efforts	45	Administrative transparency
23	Parking and information about current resources.	46	Sculptures and other art. Seating and/or dining areas. More garden spaces on East Campus. More native plants.
24	Street lights/ discussion rooms	47	Campuses need more, simple, common-sense strategies to sustainability. This could be water-bottle filling stations, dedicated bike paths, revolving doors, low-flow toilets, etcetera.
25	harder academics	48	East campus: sidewalks City campus: outdoor hang out spaces
26	"3rd" spaces outside of study areas to socialize and host events outside of residence halls and classrooms.	49	Parking for prospective student visits
27	Renewable, sustainable resources, and the transparency of current resources being used.	50	space for classrooms and studios
28	Parking	51	Recreation spaces for general population (basketball courts, swimming pools, field spaces)
29	Environmentally conscious green space, i.e. native grass lawns More opportunities for getting food/groceries beyond the food courts at the union and Selleck Libraries or media stations	52	Group/Activity Space
30	Green space (esp. City).	53	Connectivity among the campuses.
31	Space to hang out	54	using renewable energy sources, electric vehicle parking, high quality lactation spaces
32	State of the art classrooms and laboratories	55	more community feel, outdoor wireless network, food options like food carts on campus
33	Recreation spaces. Shared space for gathering, collaborating, etc.	56	Options to connect East and City Campus.
34	More trees, more flowers, and maybe decent landscaping. The UNL campus is one of the most dull-looking campus I have seen in the U.S. Also, not enough effort on prioritizing infrastructure for future-ready technology such as electric charging stations. Recycling effort also seems to be missing. It looks to me that whoever is in charge of environmental affairs just did the bare minimum and patted himself/herself for doing so. Future new buildings should strive for efficient use of space and aim for LEED-GOLD standard and no less. No idea who designed the new business building, but so much waste of space going on there.	57	The University needs to be a leader in the environmental movement and truly start taking it seriously. Do we really need to have this much grass? Turn it into a bio-diverse prairie that doesn't require watering. How about actually full fledge recycling and not forcing faculty to take out their own trash and recycling? The University needs to go all in and be a leader in the environmental movement.
35	Support for alternative modes of transportation not just between campuses but too and from campus.	58	Sustainable landscaping, more perennial/shrub beds, more low/no mow areas, more green infrastructure
36	On campus daycare options for UNL faculty/staff/students and affiliates. And a larger campus recreation facility.	59	Places for people to obtain healthy food, especially for those on the far north side of the campuses.
37	More gathering spaces	60	Academic and research spaces. Most departments are overcrowded, with insufficient faculty office and work spaces.
38	More outdoor gathering spaces. There aren't many on East Campus so they get scooped up quickly by students. It would be nice for there to be sporadic spaces across campus to be able to work or meet outside when it's nice.	61	More options for getting around and between campuses.
39	Enhancement updates to existing facilities & technology systems needed for students to be competitive in their industries. Funding for conferences & educational travel. Offices and work spaces for graduate students.	62	Education and agreement to the Master Plan concepts
40	green spaces, especially east of Selleck--the Seaton/Benton complex is an eyesore and waits valuable location space that could be better utilized for green space and better connection of residence halls to academic buildings	63	Centralized, secure bike storage options. Or, at the very least, more cameras focused on bicycle racks to discourage theft.
41	More transit options to reduce the need for cars on campus. More low-distraction study spaces for deep focus work. More library and LESS union/learning commons. Library quiet hours? Open, but restricted, WIFI access to public citizens who wish to use campus facilities	64	collaborative spaces between colleges
42	Our buildings no longer look like a cohesive campus. Oklahoma, Virginia Tech and Kansas State all have a particular style. Our campus is all over the place	65	1. Need more malls and less car traffic on campus. This has been done over and over on other campus. Change is hard but necessary to make campus more of a welcoming space. 2. More flexible spaces. We are tearing down building that are suppose to last 100s of years. We are building buildings that uses will change within the next 20 years.
		66	Green spaces that students will use, like add trees or shade, to large open areas around the perimeter
		67	Great green spaces for people. Existing open spaces are poorly scaled and do not provide pedestrian comfort. The quad at the Union is a huge missed opportunity for a great campus park.
		68	A dedicated, marked and understood bike path through campus, connecting to other city routes.

Q11

What is campus missing?

Use the comment box below to tell us:

Answered: 63 Skipped: 9

#	RESPONSES
1	More ways for students who aren't immediately on campus to get to campus to be apart of the community
2	Connections between East and City as far as relationships between the campuses. It often feels like East campus is the "lesser" of UNL properties. More availability or decreased cost for online academics. More opportunities for students to participate in activities and have it connect to their current academic classes, possibly for additional credit hours.
3	The campuses are missing spaces that everyone feels comfortable going to and studying.
4	Living wages for grad students. Pedestrian bridges. Dedicated bike paths.
5	good environment friendly spaces, a quiet reading hall with large windows, showing some open green space where bird feeders could attract native birds, and many native plants are planted would be both environment friendly, and good for mental health of students, also, we dont have scooters coffee shops on campus, there are no emergency phones to call police like these http://www.buffalo.edu/police/policing/emergency-response.html#title_1260863187
6	Would like to see some fast food restaurants at East Campus as they have in the City Campus Union.
7	East Campus has a lot of beautiful green space, however, it seems under utilized by activities. It would be nice to see students using the spaces for hobbies, lounging, frisbee or something.
8	EV charging station locations, solar and renewable public facing projects, covered 'satellite' parking
9	Efficiencies through shared functions like admissions for all campuses.
10	Probably some type of public dining option in the north or west parts of the campus. Dining halls are all over, and food trucks park by Avery Hall sometimes, but a dining option somewhere other than the City Union (kind of like the old Reunion building was) would be useful.q
11	Parking
12	Convenient places where groups of 4 to 10 people can congregate in relative isolation with access to whiteboards and power outlets. Thank heavens love learning commons exists but it'd be simpler if more of these rooms were geographically distributed.
13	Enough quiet spaces where people can be around others while still having peace and quiet, could we have some truly dedicated quite lounges in strategic parts of campus for people who want to meditate or work without being disturbed, or who want to sit on the floor and decompress etc?
14	Direct roads between all three campuses: city, innovation, & east campuses.
15	Prioritization of mass transit
16	External engagement spaces with the wider community. This can be done through existing cultural sites and open spaces.
17	Readily available environmentally grounded outdoor locations for reflection and calming
18	Accessibility and inclusive spaces
19	Outdoor ammenities such as self space
20	Hot drinking water especially in winter I miss the hammocks Resting area sounds nice
21	modern dining options
22	Prioritization of pedestrian and bike traffic.
23	A community event. Other universities have a unique event that brings everyone together with school spirit.

What is campus missing?

Use the comment box below to tell us:

24	Explicitly queer spaces Creative spaces
25	Not sure.
26	Deliberate collaboration between departments
27	specialized laboratory spaces
28	Indoor and outdoor recreation space.
29	Cultural festivals, spaces for open debates, and for religious minorities
30	Pop-up food options. Food truck fest in the east stadium loop or another central location to serve lunch options while classes are in session and the weather is nice.
31	More diverse scenery
32	Increase student space on East Campus is great but would be nice for each building, when possible, to have general spaces not necessarily for students. It would be nice to have space where faculty and staff can go to get away/interact.
33	Lack of parking close to buildings has significant impact on accessibility. Lack of a women-only gym/ pool creates hurdles for muslim and conservative women. Affordable childcare options. Family & affordable housing. Wellness activities and meetings with that consider religious and dietary restrictions
34	use of interdisciplinary student teams/classes that provide feedback on campuses; how can the research mission of UNL cycle into master planning; also lack historical references/signage/narratives that could help educate community about UNL's history, especially stories not usually represented. How can we "situate" our campus with more intentionally landmarks/signs/placards, etc.
35	More transit options to reduce the need for cars on campus. More low-distraction study spaces for deep focus work. More library and LESS union/learning commons. Library quiet hours? Open but restricted WIFI access to campus visitors/local residents who wish to use campus facilities Places to spread out and work without distraction
36	Space for alumni to come back and easily interact with the campus
37	Good bike paths
38	Nearby grocery stores and other markets needed by students. Would cut down on driving around Lincoln.
39	Administrative transparency
40	Passion. So many people are drained and have a negative outlook on the future City Campus needs a food garden.
41	Campuses are missing inclusive practices. Too often sidewalks, roads, or buildings are prohibitive to anyone who isn't fully mobile or non-impaired in any way. This creates barriers to people working and learning to their full potential as they attempt to navigate campus.
42	gathering spaces for classes
43	Pedestrian-friendly access to all areas of campus
44	green buildings with flexible outdoor learning/studio/meeting spaces
45	Connections between them.
46	Social space for faculty and staff.
47	high quality lactation spaces, solar panels - every single building should have solar panels on the roof. we should be leading the state into the future of renewable energy and we are not.
48	Dedicated staff support/relaxation spaces.

49	outdoor meeting and performance spaces
50	Outdoor gathering locations
51	Large event spaces
52	Upper administration actually getting down in the trenches to find out what the needs are and not just assuming they know. When was the last time upper administration walked through the buildings?
53	An updated, modern Admissions building. Alexander Hall is old, outdated, and unimpressive. The first stop on campus for thousands of students is Alexander Hall, and it is lacking in many areas. Meeting areas for staff and students are too small. Many areas are too cold for comfortable working conditions. More times than not, the restrooms do not have hot water. Some departments in the building don't have enough space for how many employees they have. PLEASE invest in the most important building on campus.
54	Shade in parking lots. Provide with more large maturing trees in tree islands and perimeter and/or combo PV/shade structures
55	Many buildings do not have a place where staff and faculty can go to for their break. A place that is away from students where people can relax and visit with co-workers.
56	More sustainable infrastructure.
57	Leadership on the concepts and project regarding the impact and changes.
58	A space where faculty can hold office hours outside their classroom that feels inviting.
59	student interaction spaces, indoors and outdoors
60	1. Something to direct students to/celebrate the iconic spaces on our campuses. Dedicated bike paths between campuses.
61	Places for faculty to have coffee or a beer with colleagues
62	The campus lacks a cohesive identity-- every building is different, every landscape is different.
63	Well-defined entrances for visitors. Wellness programming. Dedicated, marked and understood bike paths.

Q12

What does campus have too much of?

Use the comment box below to tell us:

Answered: 50 Skipped: 22

#	RESPONSES
1	Too much visual pride in Football athletics when so many other sports have been growing better and standing out successfully than the Football program. When you think Nebraska you think football, past greatness and current drama, but Nebraska Athletics includes so many more players who are being outstanding who have to live in the Football shadow rather than being their own thing for the UNL community.
2	Bias that benefits Athletics (including, but not limited to, the expectation that students will be offered passing grades regardless of their academic skill just because of their affiliation with specific activities and affiliation to Athletics providing additional benefits not available to others on campus), Greek housing & traditional students, as well as towards faculty (as opposed to staff). Yes, UNL is a business, but when certain parts are favored, there is a loss of beneficial and diverse knowledge. UNL has improved in being more diverse, but the barrier is still there and despite attempts to make it appear to be improving, no proof has been provided that there will be changes anytime soon.
3	The campuses have too many teachers who do not care about the wellbeing of their students.
4	Chain food businesses. Cant you have something more local or healthy to eat? We live in an agrarian state. Parking tickets. Too much space is dedicated to Greek life, which we all know is just a venue for assault and underage drinking ("b-but the alumni love it! it brings in so much money!!" too bad, oil brings in a lot of money too and we all know how harmful the oil industry is too).
5	negligence towards safety of women and LGBTQ community; microaggressions happen at the bus stops right outside city union, anybody can harrass a girl there, i have seen people multiple times there who show placards which are offensive to LGBTQ community, its sheer negligence
6	Shared bike rental depots
7	Administrators and office staff that give little value to the mission of a university. Student fees for programming that benefits very few students.
8	People :-D
9	Extraneous spending that's not well thought through.
10	Apartment-style housing.
11	Cars
12	Bird scooters
13	open spaces
14	greek life
15	Vehicle traffic between housing and class buildings.
16	Too many small classrooms. We are already struggling to find large enough rooms for our classes (before COVID-related spacing, even), and will need larger classrooms to increase enrollment.
17	Parking attendant
18	Unhealthy food sources Fraternities/sororities Environmentally-unfriendly green space
19	Vehicles.
20	Segregation
21	NA
22	Car traffic. Can be improved with parking, dedicated bicycle lanes, etc.

Q12

What does campus have too much of?

Use the comment box below to tell us:

23	Too many parking spaces, but not enough space for walking, cycling or running.
24	Streets on city campus are difficult to navigate and street conditions are poor.
25	Too much watering and mowing areas
26	Traffic through City Campus
27	Construction disruptions to others; too much administration to faculty ratio while faculty remain on pay freezes and do not have competitive wages compared to Big 10
28	buildings with stairs an entrances, lack of accessibility in many buildings even though its 2022
29	Common areas. Collaborative spaces. Reliance on cars as primary mode of student transportation Weird/trendy seating options in common areas.
30	Personal vehicles
31	Crowded areas and pavement.
32	Vehicle traffic through campus
33	Concrete (and lots of broken concrete). Too much waste - so many things are thrown away that could be recycled or better, sold or donated to be repurposed. We also have recycling containers that go unused or misused. When we try to recycle but fail, it makes the containers even more of a waste. How many times would something need to be recycled for it to offset having the containers in the first place? ya know? Might as well just throw things away because the recycling containers contribute more waste than they help offset.
34	Campuses have too much parking and general street traffic going through central corridors, high-foot traffic areas, and spaces that take away from the atmosphere of campus as a whole.
35	I wouldn't say too much, but enough with the rec fields.
36	Don't know
37	sports facilities
38	Unused space.
39	Roads for cars.
40	study/collaboration rooms with glass walls. If you want rooms like that to actually be useful, allow for privacy and minimize distractions.
41	Parking. I know ppl disagree with that, but we should discourage single person vehicles. It's ridiculous to use so much space for cars.
42	Too many housing buildings
43	Grass - make it a prairie
44	High maintenance/input landscape areas of turf, annuals, etc. Too much runoff.
45	Parking and roads.
46	nothing
47	Cars/parking on campus.
48	Sidewalks in need of repairs. Quick fixes that are temporary and eyesores for accessibility issues.
49	Way too many ornamental trees that don't provide shade or interest. Please retire the crab apple.
50	Traffic. Keep pushing it outward and do not add more parking to the core of campus.

Q13

Please rank your preference of UNL east campus circulation alternatives from favorite to least favorite?

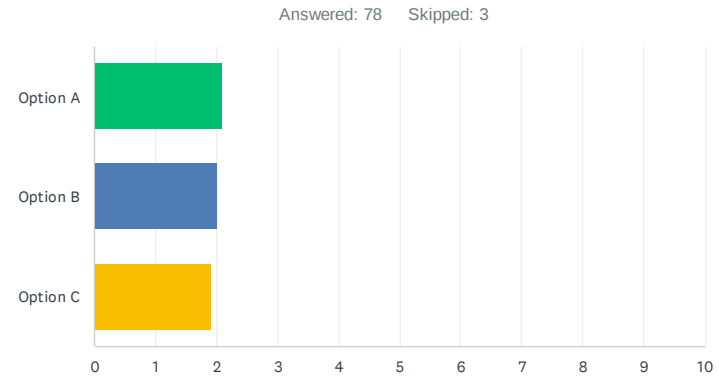

	1	2	3	TOTAL	SCORE
Option A	42.11% 32	23.68% 18	34.21% 26	76	2.08
Option B	27.63% 21	46.05% 35	26.32% 20	76	2.01
Option C	30.77% 24	29.49% 23	39.74% 31	78	1.91

Q13

OPTION A

Proposed Features

HOLDREGE ENTRIES:

- 35th, 40th, and 44th Streets

CAMPUS LOOP ROAD:

- Realignment of East Campus Loop Road. Circulates from Holdrege Street to Merrill Street (west edge of campus).

48TH STREET CONNECTION:

- Removed from Master Plan but could be added in future.

HARDIN HALL:

- Provides internal vehicular campus connection. Removes Holdrege Street connections.

INTER-CAMPUS CONNECTIVITY:

- Emphasizes connection to existing loop road access to 33rd Street.
- Provides inter-campus access to Barkley and adjacent future development.

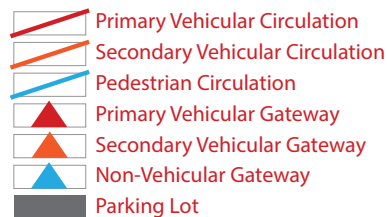
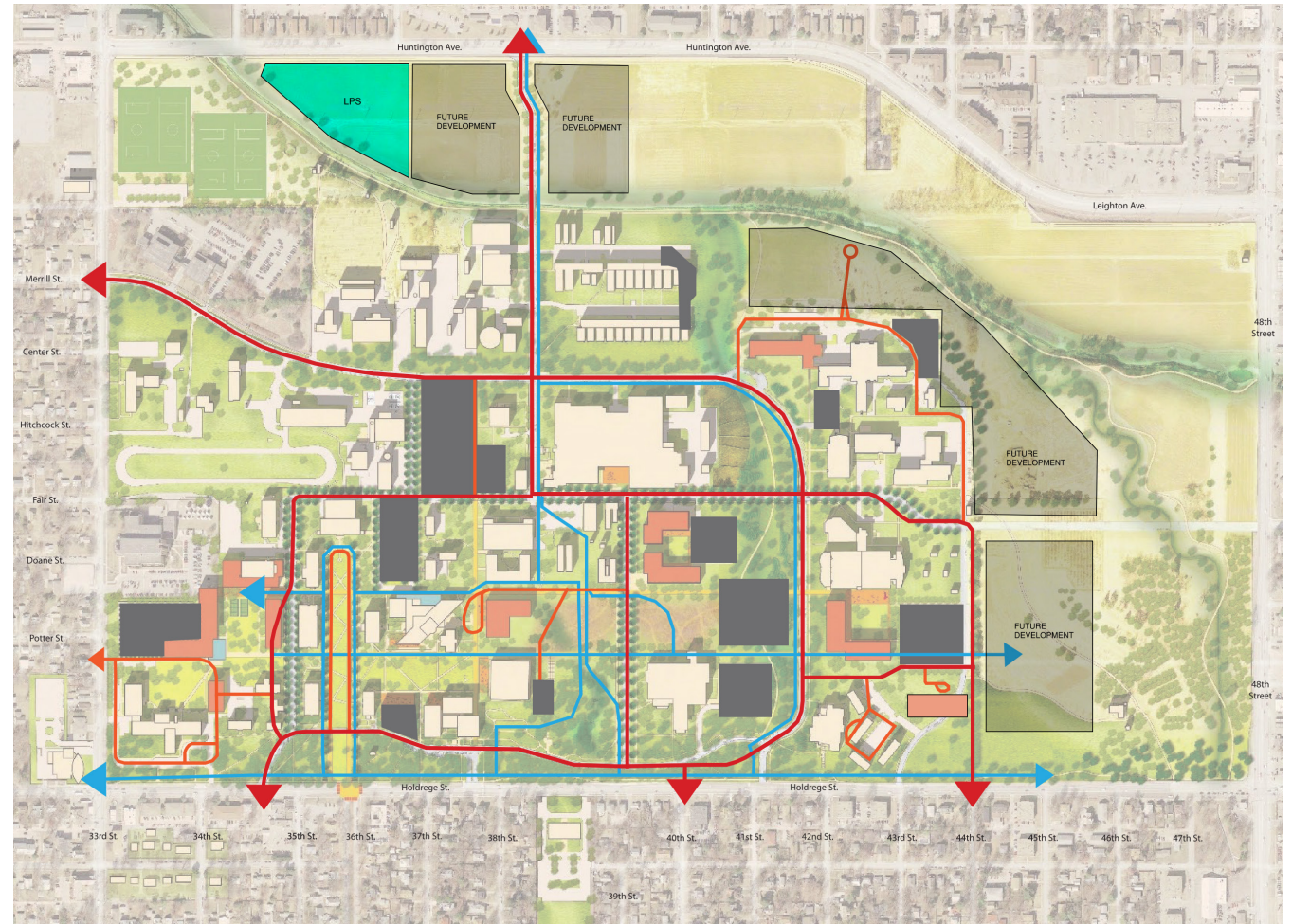

Q13

OPTION B

Proposed Features

HOLDREGE ENTRIES:

- 35th, 40th, and secondary entry at 44th Streets

CAMPUS LOOP ROAD:

- Realignment of East Campus Loop Road. Circulates from Holdrege Street to Huntington Avenue (north edge of campus).

48TH STREET CONNECTION:

- Maintained from Master Plan.

HARDIN HALL:

- Provides internal vehicular campus connection. Removes Holdrege Street connections.

INTER-CAMPUS CONNECTIVITY:

- Removes internal 39th Street vehicular circulation.
- Provides vehicular circulation north of union (with pedestrian focus relocated to south of union) to eliminate access from East Campus Mall).
- Develops secondary loop road and access to NE campus and future Rodeo from Huntington Avenue and Holdrege Street.
- Deemphasizes connection to existing loop road access to 33rd Street.
- Provides inter-campus access to Barkley and adjacent future development.

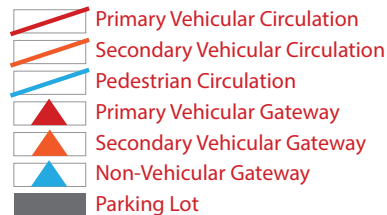
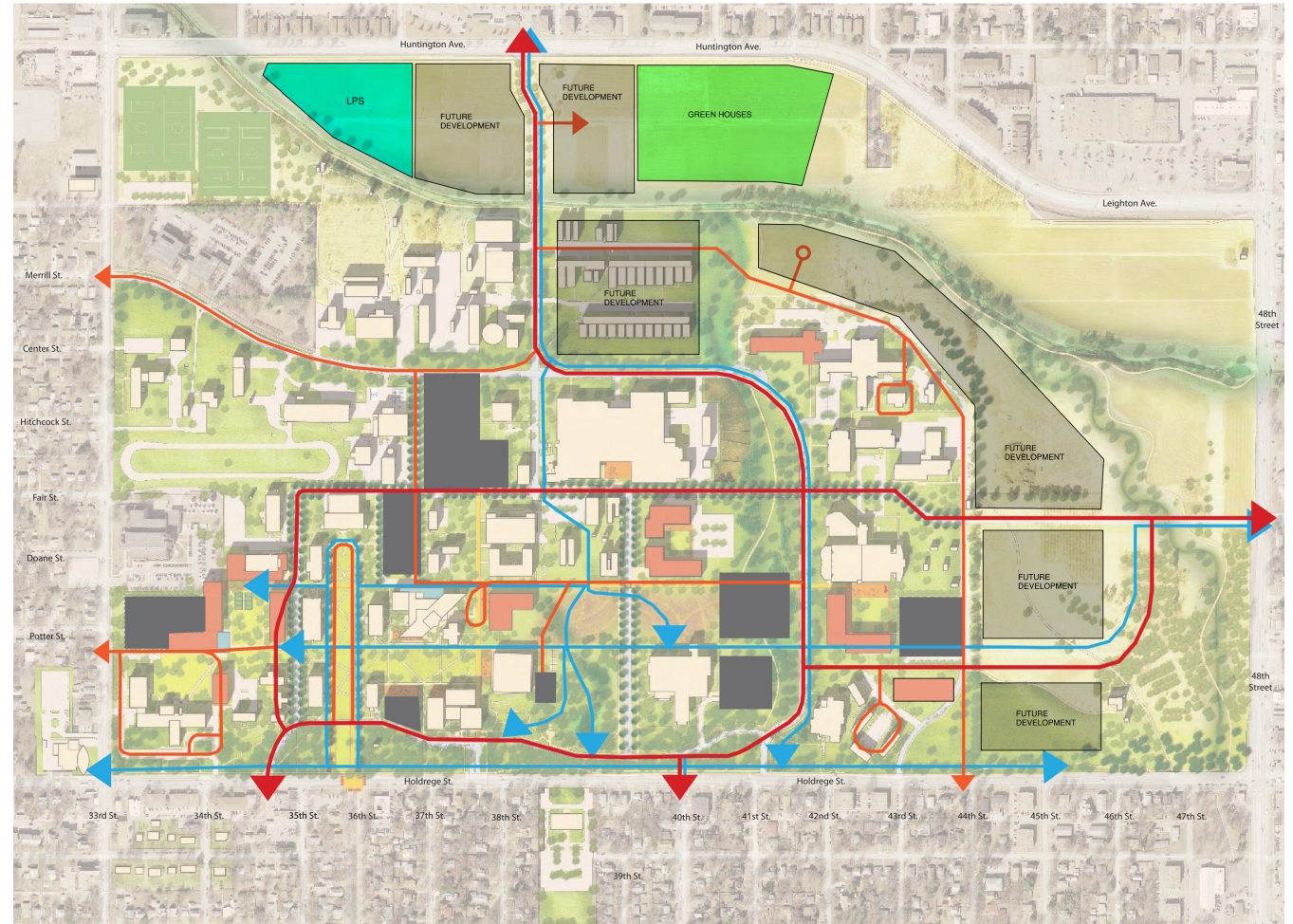

Q13

OPTION C

Proposed Features

HOLDREGE STREET ENTRIES:

- 35th, 40th, and secondary entry at 43rd Streets. Improved stacking at 40th Street.

CAMPUS LOOP ROAD:

- Realignment of East Campus Loop Road. Circulates from Holdrege Street to Huntington Avenue (north edge of campus).

48TH STREET CONNECTION:

- Maintained from Master Plan.

HARDIN HALL:

- Provides internal vehicular campus connection. Removes Holdrege Street connections.

INTER-CAMPUS CONNECTIVITY:

- Removes internal 39th Street vehicular circulation.
- Provides vehicular circulation north of union (with pedestrian focus relocated to south of union) to eliminate access from East Campus Mall).
- Develops secondary loop road and access to NE campus and future Rodeo from Huntington Avenue and Holdrege Street.
- Deemphasizes connection to existing loop road access to 33rd Street.
- Provides inter-campus access to Barkley and adjacent future development.

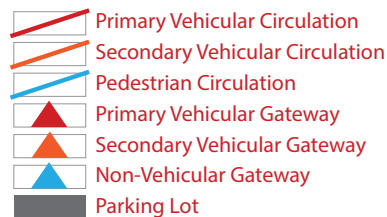
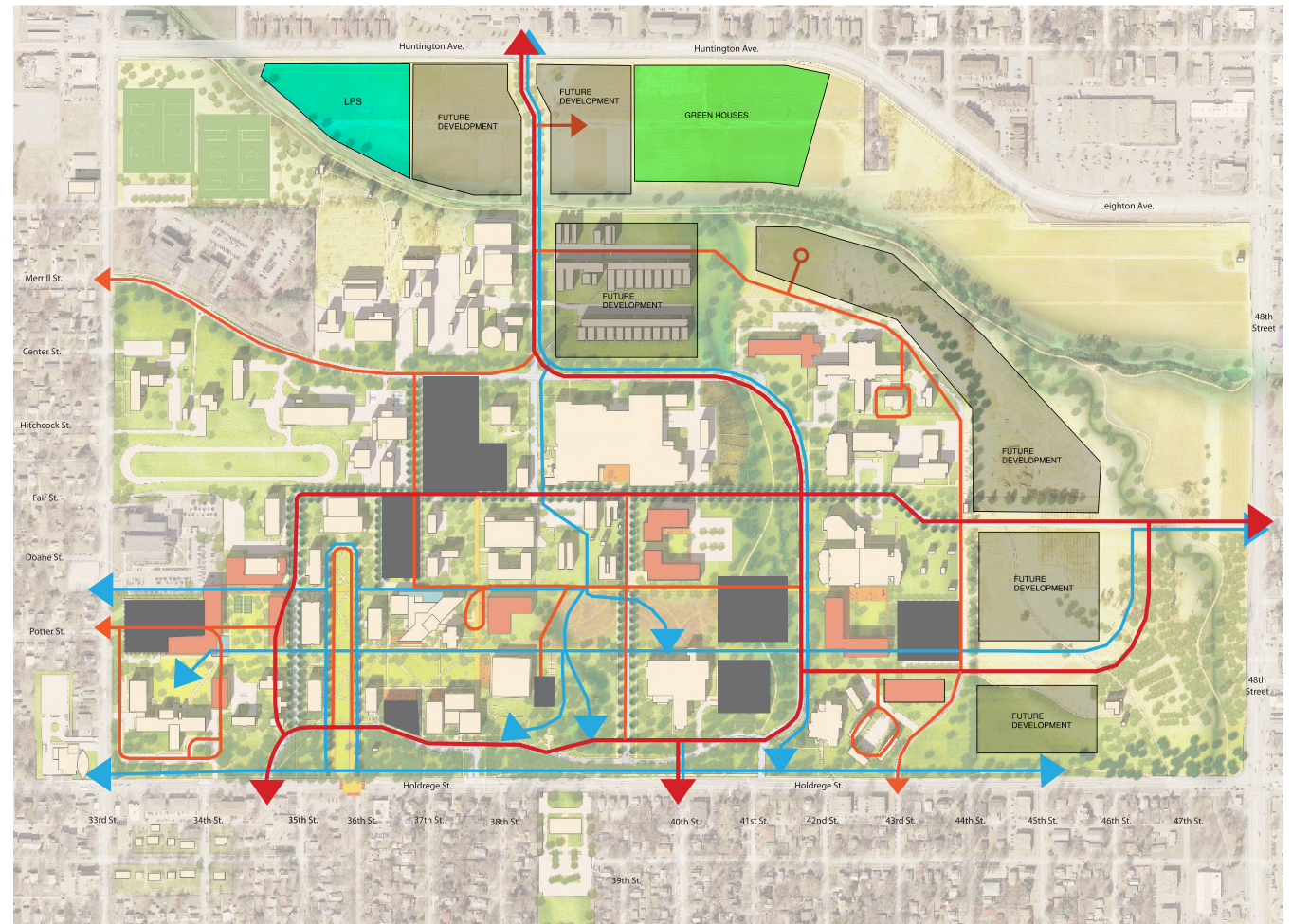

Q13

Do you have feedback on the proposed alternatives?

Use the comment box below to tell us:

Answered: 25 Skipped: 56

#	RESPONSES
1	I do not feel that a path from 48th St will do anything to benefit East campus traffic, but will instead increase high-speed traffic from people who have no need to be on East campus as they try to circumnavigate around traffic at 48th & Holdrege. East campus is well known for being environmentally friendly, and increasing traffic there will hurt the wildlife that East campus visitors and affiliates love. There need to be multiple lots that can be accessed by students and faculty/staff, and there should be at least one or two parking areas central to East campus for those who are unable to travel easily. One of the wonderful things about East campus is the natural settings that can be found there. Increasing traffic flow through those areas will only hurt the area and surrounding community.
2	It appears that all parking by the College of Law is reduced and moved a considerable distance from the school. Plus an additional building site south of the College. With each of these maps parking seems to be cut by 50% if not more. I do not find this to be acceptable as we will be forced to fight for parking as happens on city campus today.
3	There are elements of B and C that I prefer, but it is a mix of preferences. I like the addition of access to 48th St. That would be very helpful for access to the east side of campus. I prefer the straight easterly access to 48th St that is included in Option B, as well as the continued primary vehicular circulation along the NE quadrant of the East Campus Loop. But I am intrigued by the idea of eliminating the Y gateway at 35th and Holdrege.
4	there should be more storm-safe passage ways between different halls at each campus
5	I think making the loop flow more logically as is proposed in Option A is probably the best. I don't see the need for an entrance to 48th street as in Options B and C. I would rather the entrance to the East campus loop not be eliminated at 35th Street. I like the proposal to fix the Y corner but not eliminate the entrance altogether.
6	Maintain undeveloped green spaces as much as possible. Do not prioritize vehicular convenience. Do not encourage drive-throughs.
7	It would be a HUGE mistake to create access via 48th Street.
8	There is currently a backup when exiting the campus in front of the Dairy Store, as only a few cars can fit (and turn left/East) between the East Campus Loop Road and Holdrege. Flow needs to be updated there.
9	I don't really like any of these. The traffic at east campus isn't that bad to deal with, frankly.
10	NA
11	Fewer vehicle conflicts with the existing bike infrastructure and more emphasis on bicycle routes would make bicycling more appealing.
12	I made selections and comments for this survey--twice. I 'done' button the first time thinking it would take me to the next screen, it didn't, and I lost where I was. The second time I hit the back button when I was on this page to review a previous answer. Guess what, yes, I lost all my input. I am quitting now as I cannot spare more time on this feedback. Best of luck with the planning and implementation. By the way do you have a summary of what has been accomplished from the last master plan to reference?
13	Need more access for traveling east on Holdrege and need access to 48th street
14	Please including huntington avenue a lot of students live here north or east campus but there are no bus stops

Do you have feedback on the proposed alternatives?

Use the comment box below to tell us:

Q13

15	EC interior roads are WAY too narrow to support any of these options - especially if you reduce access to/from Holdrege street. More traffic control devices are needed for each of these gateways - both car and pedestrian. Pedestrian warning lights at Idywild have been a huge help. Develop more remote parking lots w/small shuttle access to and from to keep cars out of EC interior. Incentives to keep students/staff from parking in adjacent neighborhoods More parking for Dairy Store customers! Change Vine/Holdrege bus routes so they serve different areas and reduce their overlapping routes. If you take away Dairy Store Dr. entrance - create more customer parking there.
16	I understand that it would make campus more accessible if there was a road connecting East Campus to 48th street. But if you pave a road, all of that green space will start to fill up with parking lots/garages, buildings, etc. Slippery slope
17	I think it's a bad idea to cut through research area. On-campus research is important for students to see/have access to. Inviting the public into these spaces by major roadways is a bad idea. Not to mention the environmental impact the increased stormwater will have on the land.
18	All these Options show, but it is not mentioned much less pointed out, making Fair a through street from 35th on the west, to at least the East Campus Loop on the east. Don't like the way A has straight across East Campus Loop at 39th... The turn currently required and bringing back entry/exit at 40th, as in B & C, serves as a deterrent/control of speed.
19	I have no idea what "realignment" of the loop means, and it's hard to judge these plans without a reference to what the existing set up is. That being said, I always feel lost when trying to navigate east campus, and whatever you do, it would be helpful to have signs that say things like "to Holdrege St." with arrows for the various getaways.
20	The addition of a road to the west is a great idea. Getting vehicles to the center of East Campus is very difficult right now. Additional traffic light considerations to make turning onto 33rd or Holdrege more accessible would be helpful. There is a good amount of foot traffic crossing Holdrege so ways to veer campus traffic off of the campus stretch of Holdrege would be nice.
21	Who really goes to east campus that much? There is so much desire to inter connect the campuses but they really aren't. They should be treated as two separate campuses.
22	Less vehicular access to the campus is better as long as more pedestrian routes and bikeways are prioritized.
23	None of these plans add a sidewalk or bike route by the Ruth Staples lab south of the tractor test lab. I've walked that curve several times on evening strolls and each time I forget just how dangerous that is. Please add a plan to create a pathway should someone find themselves walking on that part of campus.
24	There is not a pedestrian circulation emphasis in C to across to the Rec & Wellness Center. I think this separates Massengale and other residents too much across 35th street.
25	parking lots are bad on all schemes. Consider streetscapes that can provide some on street parking. Conversely, when parking lots are required, let's make them innovative stormwater collection zones instead of big, hot asphalt planes. The less internal vehicular circulation the better.

B

APPENDIX

Section B - Appendix documents the conceptual alternatives developed based on the UNL Selleck Study Planning Committee design criteria and key comments through the review process.

ACKNOWLEDGMENTS

UNL SELLECK STUDY PLANNING COMMITTEE

Anna Pressler - Director, Operations & Marketing, Jeffrey S. Raikes School of Computer Science and Management

Brooke Hay - Assistant Vice President/Director of Capital Construction, Facilities, Planning & Capital Programs

Charlie Francis - Director, University Housing

Dave Annis - Director, University Dining Services

Emily Deeker - Director, Campus Planning and Environment

Josh Overocker - Associate Vice Chancellor, Student Affairs

Larry Shippen - Director, Housing Facilities Operations

Renee Batman - Assistant Vice Chancellor, Academic Affairs

Stephen Cooper - Executive Director & Chancellor's Professor, Jeffrey S. Raikes School of Computer Science and Management

The UNL Selleck Study Planning Committee developed design criteria for the future replacement of the Selleck Quadrangle Housing Complex, Selleck Dining Center, former University Health Center Building site, as well as, design criteria for the expansion of Kauffman Academic Residential Center. Through several review forums the committee evaluated conceptual alternatives to develop a preferred conceptual plan. This preferred conceptual plan is included in the 2022 UNL Facilities Development Plan Update.

The following appendix pages document the conceptual plan alternatives reviewed by the committee.

INTRODUCTION

As a part of the 2022 University of Nebraska-Lincoln FDP update (Plan), the Executive Campus Planning Committee suggested a sector study of the area from S Street to Vine Street and 15th Street to 16th Street as illustrated in **Figure B1.1**. The planning committee recognized the opportunity to coordinate the unique future needs for this area of campus as Housing and Dining Services and the Jeffery S. Raikes College of Computer Science and Management (Raikes) review and plan expenditures for their capital projects over the next five years.

Since the 1950's this location has served as housing and student dining. Maintaining housing and dining at this central location was supported by the 2018 Honors Housing Study. This area of campus currently includes a variety of uses including student housing, student dining, academic offices, potential office and lease space. The facilities have been identified for future replacement to meet future housing and dining needs and aspirations. Redevelopment of the sector study area would need to be phased to maintain existing dining service and a portion residential facilities.

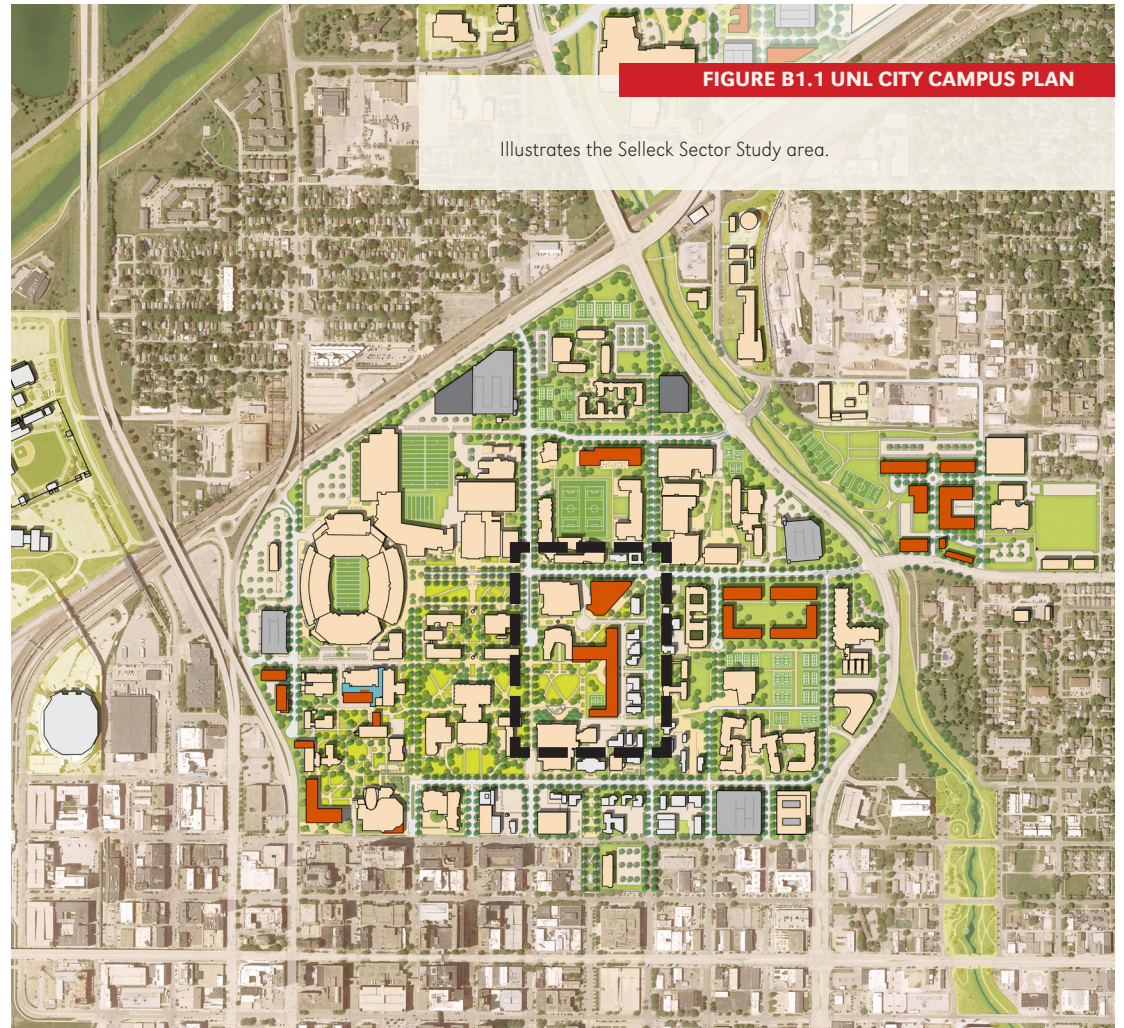

DESIGN CRITERIA

To capture current aspirations, needs, and opportunities Selleck Sector Study stakeholders were engaged through virtual and in-person work sessions. Stakeholders were assembled to further understand facility development needs related to student life, academics, dining, residential amenities, circulation, and their associated service requirements. Conversations were facilitated to understand needs and desires, short-term and long-term aspirations, and the timing of their implementation or need. Efficiencies, operations, and phasing were considered as part of these interactive sessions.

Facility Context

The following were identified as facility projects within and adjacent to the study area:

- Benton, Fairfield, and Seaton Halls are scheduled for deconstruction upon the vacation of Seaton Hall. Time frame of deconstruction is anticipated within one year.
- University Health Center is also planned for deconstruction. Time frame of deconstruction is unknown as the facility is currently utilized for flexible “hoteling” space.
- Piper Hall is planned for deconstruction in 2022. The site is planned for open space.

Phasing and Capacity

The following facility context and design criteria were identified for the Selleck Quadrangle (Selleck) and Raikes:

- Selleck phasing will be a critical aspect to this project to maintain dining and partial residential service through implementation.
 - Dining will have to be coordinated before existing dining facilities are deconstructed.
 - Bed count not as much of a concern due to current housing capacity.
 - All current utilities run right through dining.
- Anticipated Selleck phasing would be to redevelop the northern residential facilities, followed by the southern residential facilities, followed by the dining in the center.
- Phasing for Raikes shall consider growth will occur over time. Recognized advantage to partnership with Selleck phasing to allow for long-term growth without the need for repetitive capital construction projects.

Selleck Quadrangle

The following facility context and design criteria were identified:

- Selleck is an older residence hall at the end of its useful life.
- 10-15 million in deferred maintenance costs for Selleck that wouldn't do anything to improve student life
- Selleck currently houses older students wanting single rooms.
- Preference is to maintain as a central campus residence hall and dining facility.
- Desire more residential density within the center of campus.
- Anticipate 1,200-1,500 beds for the replacement facility with a mix of traditional and suite style rooms.
- Anticipate first phase of residential would target first year students to facilitate student success.
- Anticipate the dining facility could replace the Abel/Sandoz Hall dining facility in the future.
- Redevelopment facility will need:
 - Greenspace for residents, study lounges, and passive programmed spaces.
 - Dog amenities as 18% of students currently have comfort animals.
 - Dining center service dock and egress to accommodate semi-trailers and service trucks.
- Need to maintain up to 20 ADA parking stalls required for campus.
- Move-in and move-out must be accommodated.

Raikes

The following facility context and design criteria were identified:

- Raikes is an honors program with approximately 145 students located in Kauffman Academic Residential Center (Kauffman).
- Most students only have classes with other Raikes students and only classes in Kauffman.
- Expansion of program would create need for expansion of classroom, office space, student collaboration, and residential housing space.
- Time frame for expansion could potentially be immediately with university support of financial scholarships.
- Currently offers 116 beds with a guest room on first floor.
- Desire to add 60 students to the program in short-term. Anticipate need for 230-260 beds with current growth.
- Opportunity for Selleck replacement facility to include residential and academic spaces for Raikes.
- Preference is to require a physical connection to Kauffman for any Raikes residential or academic space.
- 15th Street could potentially be removed to accommodate expansion of Kauffman.
- Desire to maintain greenspace to the south of Raikes as it is well used by Raikes and all UNL students.
- Current challenge with move-in and move-out due to building access and lack of wayfinding.
- Service will need to be maintained at the NE corner of Kauffman.

PREFERRED CONCEPT SKETCH

The following describes the features identified in **CONCEPT B1.2**.

Proposed Features

UNIVERSITY HEALTH CENTER SITE:

- Central campus dining center with residential housing above.
- Current pedestrian connection between University Health Center and College of Business is converted to service plaza.
- Pedestrian connectivity is realigned to corner of Vine and N. 16th Streets to activate underutilized campus area and develop pedestrian corridor to center of campus.
- Opportunity for rooftop and courtyard dining plus residential roof amenities.
- Service access is provided to and/or from Vine and U Streets.

SELLECK QUADRANGLE SITE:

- Landscape and vehicular corridor for service and potentially permit parking is provided as a buffer to adjacent non-UNL facilities.
- Conversion of N. 15th Street to a pedestrian corridor with limited service and emergency access between S and U Streets.
 - This connectivity is maintained through a breezeway below the Kauffman connection.
- Kauffman residential and academic expansion is provided within the first phase of the residential facility. The location provides the physical connection to Kauffman and accommodates the honors program's projected growth without the need for further capital construction.
- Residential facilities create two additional courtyards for open space, recreation, wellness, pet, and academic amenities and programming.
 - The southern courtyard serves as an extension of the Meier Commons and Plaza.
 - The northern courtyard creates an open space amenity at the terminus of the U Street pedestrian corridor and pedestrian connectivity to northeast campus.
- Residential facility development is phased to accommodate relocation of dining center to the University Health Center Site.
- Pedestrian connectivity is provided to corner of Vine and N. 16th Streets and courtyard adjacent to proposed central campus dining and residential facility.
- Residential car court and entry is created at the Terminus of T Street with views and access to the Meier Commons.
- ADA parking is provided within the vehicular corridor along S Street.

CONCEPT B1.2 PREFERRED CONCEPT PLAN

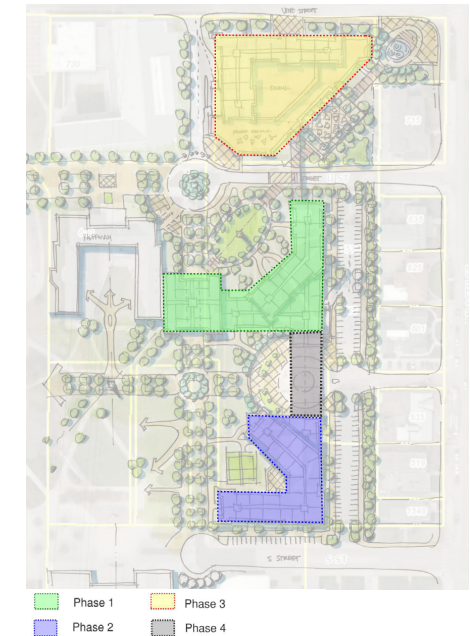

REFINED CONCEPT SKETCHES

The following concept alternatives illustrated in **CONCEPT B1.3** and **B1.4** were refined in response to stakeholder comments on the preliminary conceptual alternatives.

CONCEPT B1.3 REFINED CONCEPT ALTERNATIVE - C

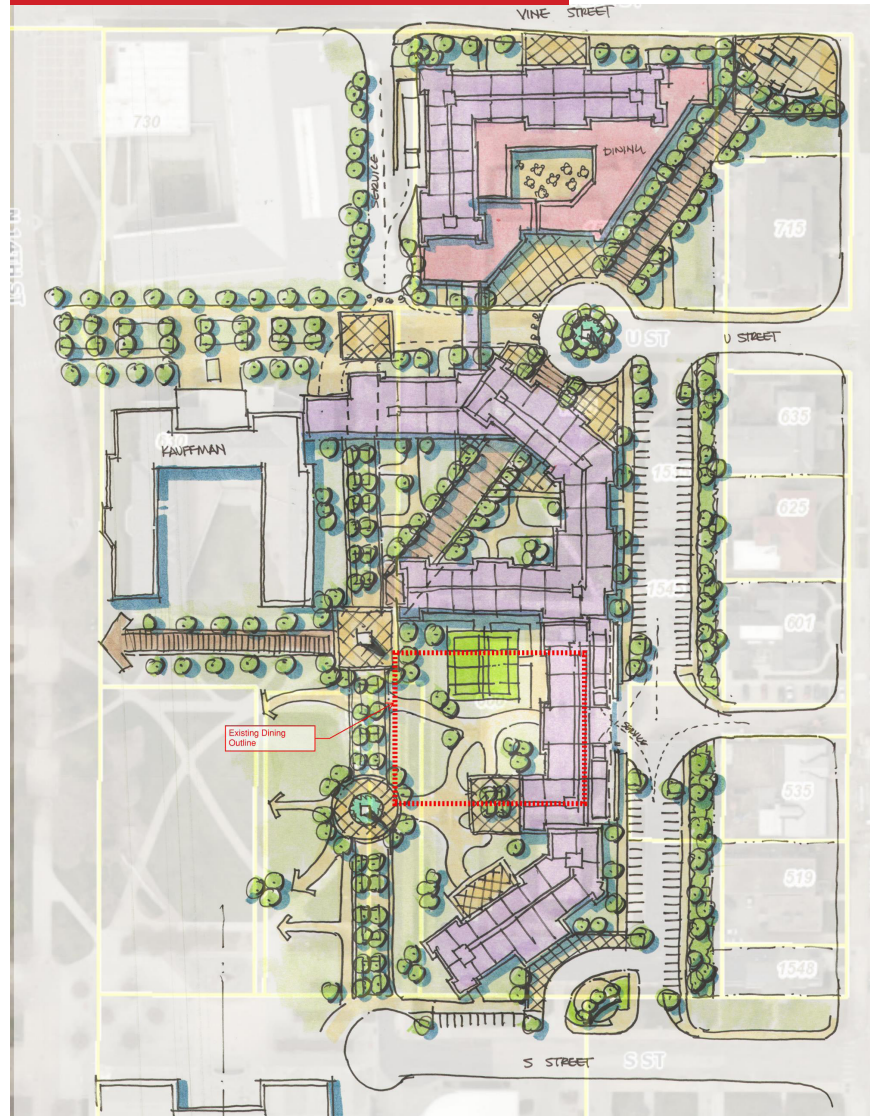

CONCEPT B1.4 REFINED CONCEPT ALTERNATIVE - E

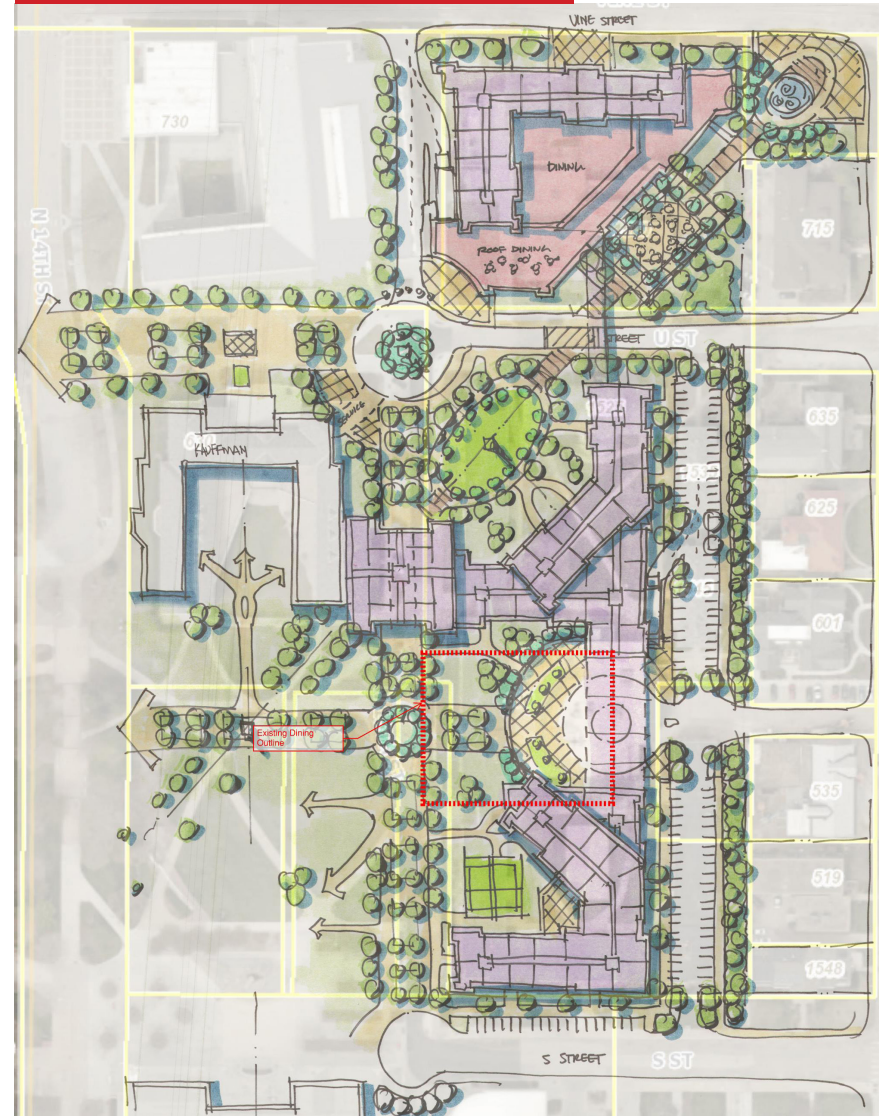

CONCEPT ALTERNATIVE SKETCHES

The following concept alternatives illustrated in **CONCEPT B1.5**, **B1.6**, **B1.7**, **B1.8**, and **B1.9** were developed to explore plan alternatives addressing the stakeholder design criteria.

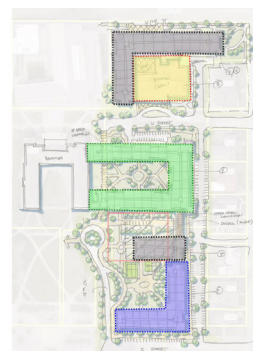
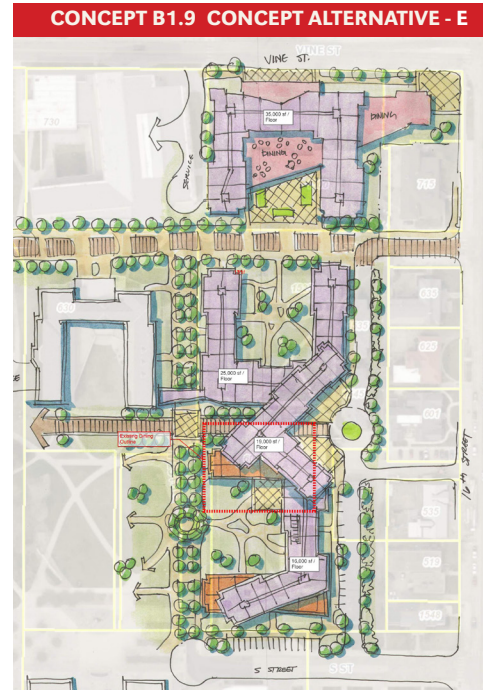
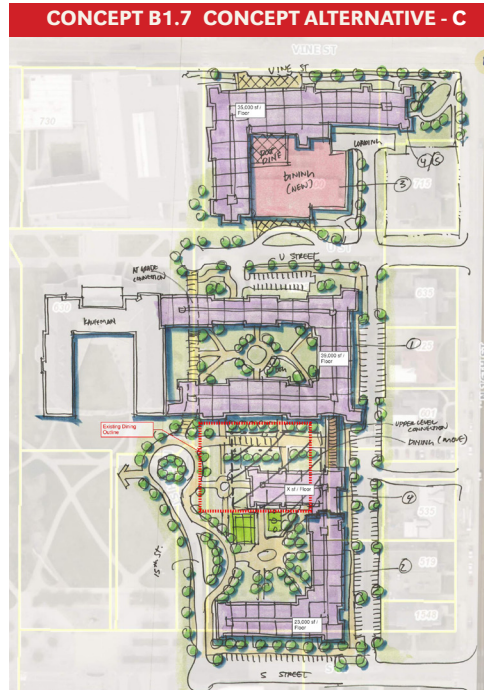
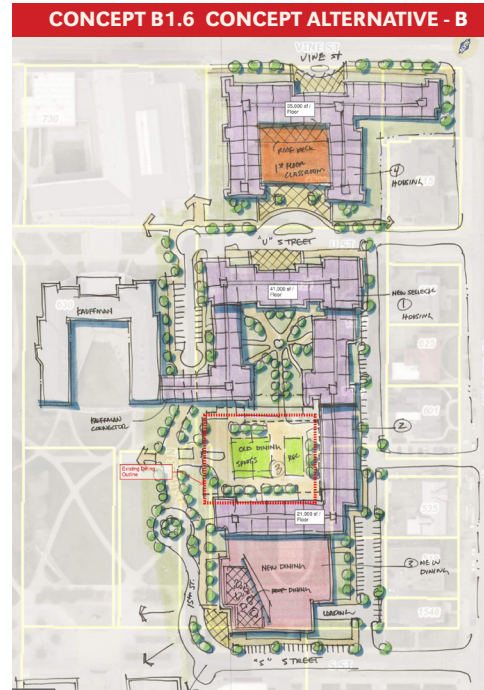
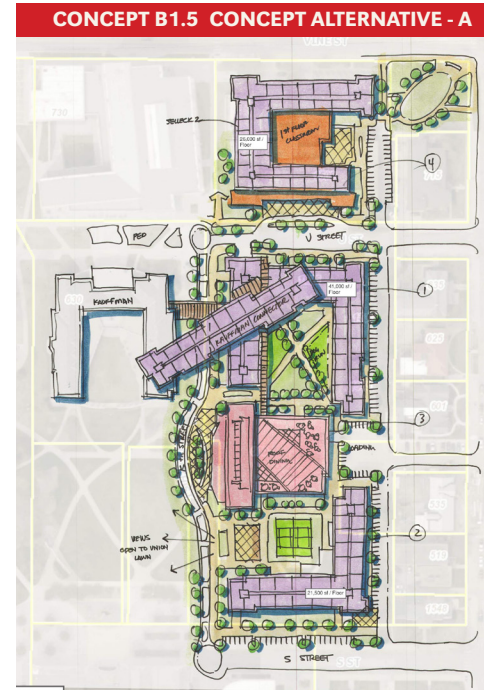

- Phase 1
- Phase 2
- Phase 3
- Phase 4

N